

24x60 Site Trailer

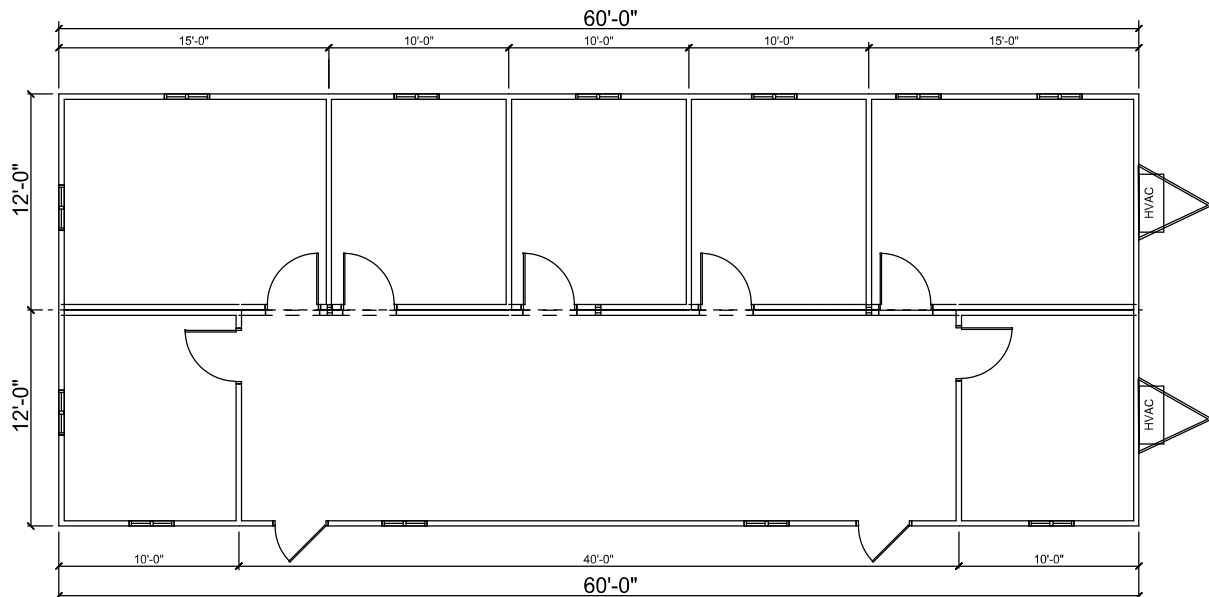
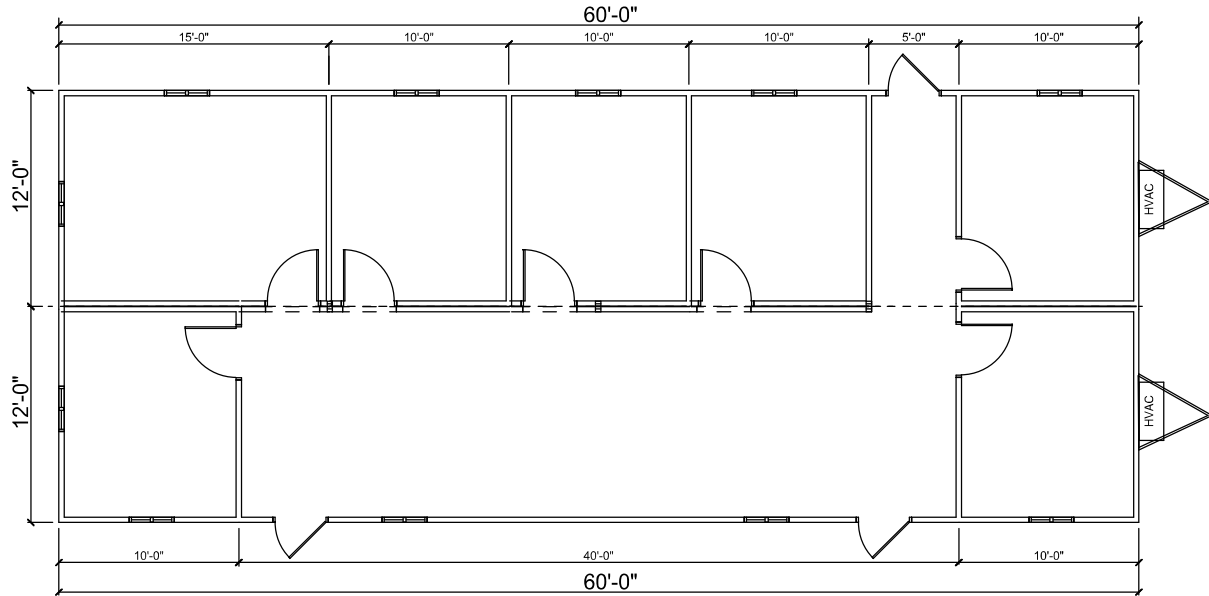

STANDARD FEATURES

INTERIOR FINISHES

Flooring: Vinyl composite tile.
Walls: Wood grain / vinyl finished wood paneling
Ceiling: Suspended metal grid with 2'x4' ceiling tiles.

EXTERIOR DOORS

34" x 80" metal clad solid slabs in aluminum frame complete with check chain and lock set.

WINDOWS

32" X 40" double pane aluminum windows with lock and insect screen

ELECTRICAL

Electrical Service: 120/240 single phase.
Service Entrance: Rigid nipple to exterior.
Lighting: 2'x4' (4) tube recessed fluorescent fixtures with acrylic lens.
Outlets: To suit floor plan
Switching: To suit floor plan

HEATING AND COOLING

Exterior mounted HVAC units with supply ducts located in the ceiling cavity.

SITE EQUIPMENT

(1) Knock down steel framed entry system with pressure treated wood treads and landing per door. Galvanized steel leveling stands to suit trailer size.

OPTIONAL ITEMS

Washrooms, kitchenettes, skirting

TURKSTRA TRAILERS

1-800-265-9999